

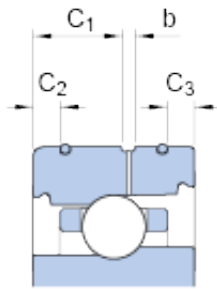

Timken Bearing Company

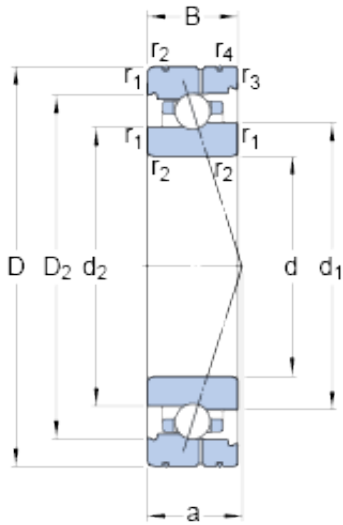

65 mm x 90 mm x 13 mm SKF 71913 CB/P4AL Radial thrust ball bearing

Bearing No. 71913 CB/P4AL

71913 CB/P4AL Bearing 2D drawings and 3D CAD models

Size	90x65x13 mm
Bore Diameter	90 mm
Outer Diameter	65 mm
Width	13 mm
d	65 mm
D	90 mm
B	13 mm
d ₁	73.94 mm
d ₂	72.72 mm
D ₂	83.46 mm
b	2 mm
C ₁	6.5 mm
C ₂	3.8 mm
C ₃	1.7 mm
r _{1,2} - min.	1 mm
r _{3,4} - min.	0.3 mm
a	20.1 mm
d _a - min.	69.6 mm
d _b - min.	69.6 mm
D _a - max.	85.4 mm
D _b - max.	88 mm
r _a - max.	1 mm
r _b - max.	0.3 mm
d _n	74.8 mm



Timken Bearing Company

Basic dynamic load rating - C	10.6 kN
Basic static load rating - C ₀	9.5 kN
Fatigue load limit - P _u	0.4 kN
Limiting speed for grease lubrication	20000 r/min
Limiting speed for oil lubrication	30000 mm/min
Ball - D _w	5.556 mm
Ball - z	32
G _{ref}	2.96 cm ³
Calculation factor - f ₀	9.9
Preload class A - G _A	35 N
Preload class B - G _B	70 N
Preload class C - G _C	210 N
Calculation factor - f	1.13
Calculation factor - f	1
Calculation factor - f _{2A}	1
Calculation factor - f _{2B}	1.02
Calculation factor - f _{2C}	1.07
Calculation factor - f _{HC}	1
Preload class A	38 N/micron
Preload class B	51 N/micron
Preload class C	81 N/micron
d ₁	73.94 mm
d ₂	72.72 mm
D ₂	83.46 mm
C ₁	6.5 mm
C ₂	3.8 mm
C ₃	1.7 mm
r _{1,2} min.	1 mm



Timken Bearing Company

$r_{3,4}$ min.	0.3 mm
d_a min.	69.6 mm
d_b min.	69.6 mm
D_a max.	85.4 mm
D_b max.	88 mm
r_a max.	1 mm
r_b max.	0.3 mm
d_n	74.8 mm
Basic dynamic load rating C	14.3 kN
Basic static load rating C_0	15.3 kN
Fatigue load limit P_u	0.4 kN
Attainable speed for grease lubrication	20000 r/min
Attainable speed for oil-air lubrication	30000 r/min
Ball diameter D_w	5.556 mm
Number of balls z	32
Reference grease quantity G_{ref}	2.96 cm ³
Preload class A G_A	35 N
Static axial stiffness, preload class A	38 N/ μ m
Preload class B G_B	70 N
Static axial stiffness, preload class B	51 N/ μ m
Preload class C G_C	210 N
Static axial stiffness, preload class C	81 N/ μ m
Calculation factor f	1.13
Calculation factor f_1	1
Calculation factor f_{2A}	1
Calculation factor f_{2B}	1.02
Calculation factor f_{2C}	1.07
Calculation factor f_{HC}	1



Timken Bearing Company

Calculation factor f_0	9.9
Mass bearing	0.21 kg