

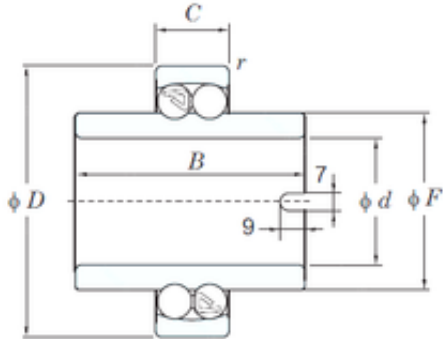

Timken Bearing Company

40 mm x 90 mm x 58 mm KOYO 11308 Self adjusting ball bearing



Bearing No. 11308

Size	40x90x58 mm
Bore Diameter	40 mm
Outer Diameter	90 mm
Width	58 mm
d	40 mm
D	90 mm
B	58 mm
C	23 mm
r min.	1.5 mm
F	57.7 mm
Da max.	82 mm
ra max.	1.5 mm
Weight	1.09 Kg
Basic dynamic load rating (C)	29.5 kN
Basic static load rating (C0)	9.70 kN
(Grease) Lubrication Speed	6900 r/min
(Oil) Lubrication Speed	8400 r/min
Calculation factor (e)	0.25
Calculation factor (Y0)	2.69
Calculation factor (Y1)	2.57

11308 Bearing 2D drawings and 3D CAD models