

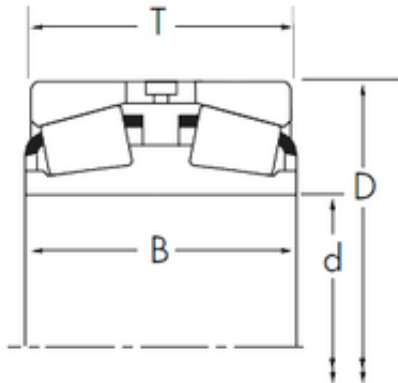

Timken Bearing Company

92,075 mm x 149,225 mm x 57,942 mm Timken
42362D/42587 Tapered roller bearing



Bearing No. 42362D/42587

Size	92.075x149.225x63.5 mm
Bore Diameter	92,075 mm
Outer Diameter	149,225 mm
Width	63,5 mm
d	92,075 mm
D	149,225 mm
T	63,5 mm
B	57,942 mm
R	1,5 mm
r	3,3 mm

42362D/42587 Bearing 2D drawings and 3D CAD models