

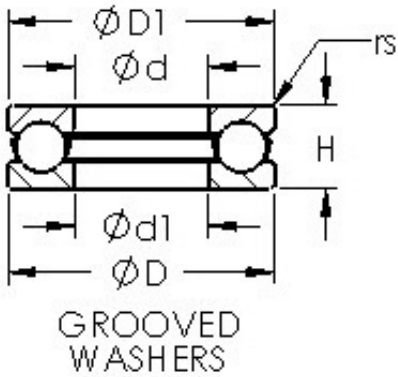

Timken Bearing Company



AST 51268M Thrust ball bearing

Bearing No. 51268M

Bore Diameter	340 mm
Outer Diameter	460 mm
Bearing Type	with grooved raceway(s)
Bore Dia (d)	340.0000
Outer Dia (D)	460.0000
Radius (min) (rs)	3.000
Static Load Rating (Cor)	3,074,000
Dynamic Load Rating (Cr)	627,000
Max Speed (Grease) (X1 RPM)	0
Max Speed (Oil) (X000 RPM)	1
Height (H)	96.0000
Outer Dia. Pilot (D1)	455.0000
Bore Dia. Clearance (d1)	345.0000
Weight (g)	46,609.00
Material	52100 chrome steel, or equivalent.

51268M Bearing 2D drawings and 3D CAD models